

ATTACHMENT A

Lancaster Drainage Benefit Assessment District Annexations

Annexation No.	Project	Location	Developer	Estimated 1st Year's Maintenance Cost
06-50	Permit No. 06-02276	north side of Avenue L-4, approximately 335 feet east of 15th Street West (single-family residential)	Anthony L. Pulliam and Bonny E. Pulliam, husband and wife as joint tenants	\$56.46
07-51	Site Plan Review No. 06-19	north side of Avenue L-12, approximately 330 feet east of 5th Street East (commercial)	Hagop Harouteoun Ketenjian and Cynthia Mary Ketenjian, trustees of the Hagop and Cynthia Ketenjian Living Trust dated May 3, 1999	\$545.40
07-59	Permit No. 07-01218	south side of Avenue M, approximately 250 feet west of 35th Street West (single-family residence)	Camino Hermanos I, LLC	\$56.46
08-17	Permit No. 07-03714	northeast corner of Avenue H-6 and 30th Street East (single-family residence)	Josephine Roman, an unmarried woman	\$56.46
08-18	Permit No. 07-04219	513 East Nugent Street (single-family residence)	Josephine Roman, an unmarried woman	\$56.46
08-20	Site Plan Review No. 07-15	southeast corner of Avenue K and 6th Street East (commercial)	Yasser Mubarkeh and Nashwa Mubarkeh, husband and wife as joint tenants as to an undivided 50% interest and Elias Mbarkeh and Kahramanah Mbarkeh husband and wife as joint tenants as to an undivided 50% interest	\$1,192.09

DIAGRAM FOR
PROPOSED ANNEXATION NO. 06-50
LANCASTER DRAINAGE MAINTENANCE DISTRICT
CITY OF LANCASTER
COUNTY OF LOS ANGELES, STATE OF CALIFORNIA

DIAGRAM PREPARED IN THE OFFICE OF PUBLIC WORKS DIRECTOR
CITY OF LANCASTER

PREPARED BY:

CARLYLE S. WORKMAN, CITY ENGINEER
R.C.E. C45024, EXPIRES 3/31/10

FILED IN THE OFFICE OF CITY CLERK OF THE CITY OF LANCASTER THIS
DAY OF _____, 2008

GERI K. BRYAN, CITY CLERK
CITY OF LANCASTER

LEGEND

_____ BOUNDARY OF PROPOSED ANNEXATION

A DETAILED DESCRIPTION OF THE LINES AND DIMENSIONS OF THE
PARCEL SHALL BE AS SHOWN ON LOS ANGELES COUNTY ASSESSORS
MAPS FOR FISCAL YEAR 07-08 AS INDICATED BELOW AND SHALL
GOVERN FOR ALL DETAILS.

ASSESSOR MAP, PAGE, AND PARCEL 3109-026-024.

THIS DIAGRAM IS BEING FILED IN THE CITY CLERK'S OFFICE AT THE
REQUEST OF THE DIRECTOR OF PUBLIC WORKS.

THE 1 LOT WITHIN PMT 06-02276 IS SUBJECT TO ANNUAL
ASSESSMENTS BY THE CITY OF LANCASTER FOR THE MAINTENANCE OF THE
DRAINAGE IMPROVEMENTS WITHIN THE DRAINAGE MAINTENANCE DISTRICT.

THE AREA OF THIS ASSESSORS PARCEL WAS SUBSEQUENTLY APPROVED
FOR DEVELOPMENT, KNOWN AS PMT NO, 06-02276.

THE CITY COUNCIL APPROVED ANNEXATION OF THIS PARCEL ON
JULY 8, 2008.

OWNERS: ANTHONY L. PULLIAM AND BONNY E. PULLIAM, HUSBAND AND WIFE AS JOINT TENANTS

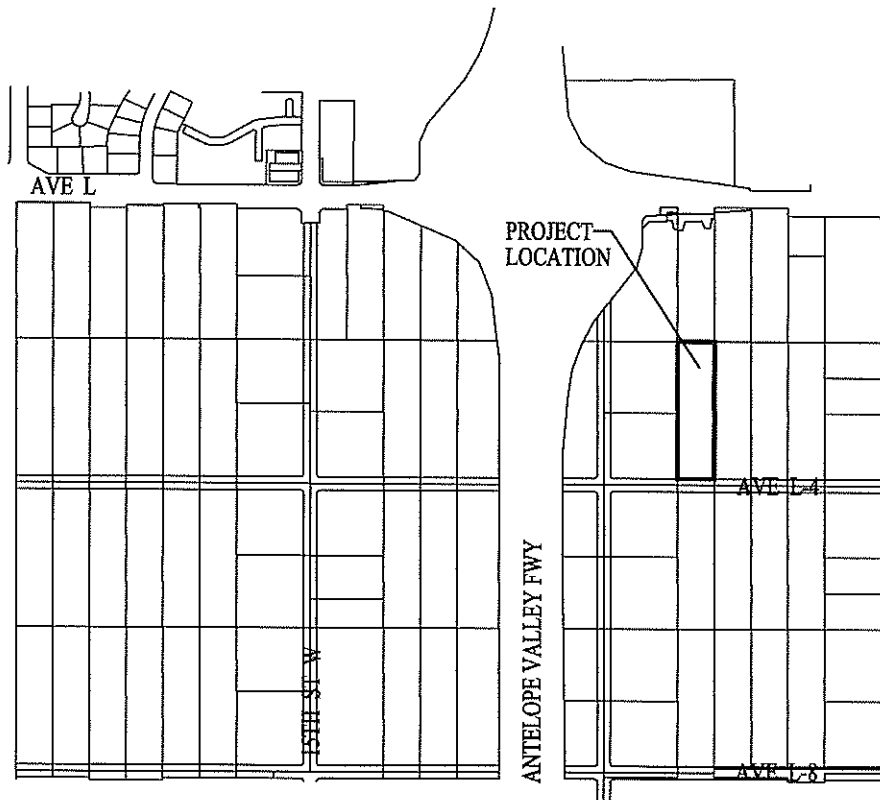

EXHIBIT "A"

DIAGRAM FOR
PROPOSED ANNEXATION NO. 07-51
LANCASTER DRAINAGE MAINTENANCE DISTRICT
CITY OF LANCASTER
COUNTY OF LOS ANGELES, STATE OF CALIFORNIA

DIAGRAM PREPARED IN THE OFFICE OF PUBLIC WORKS DIRECTOR
CITY OF LANCASTER

PREPARED BY:

CARLYLE S. WORKMAN, CITY ENGINEER
R.C.E. C45024, EXPIRES 3/31/10

FILED IN THE OFFICE OF CITY CLERK OF THE CITY OF LANCASTER THIS
____ DAY OF _____, 2008

GERI K. BRYAN, CITY CLERK
CITY OF LANCASTER

LEGEND

_____ BOUNDARY OF PROPOSED ANNEXATION

A DETAILED DESCRIPTION OF THE LINES AND DIMENSIONS OF THE
PARCEL SHALL BE AS SHOWN ON LOS ANGELES COUNTY ASSESSORS
MAPS FOR FISCAL YEAR 07-08 AS INDICATED BELOW AND SHALL
GOVERN FOR ALL DETAILS.

ASSESSOR MAP, PAGE, AND PARCEL 3126-016-039.

THIS DIAGRAM IS BEING FILED IN THE CITY CLERK'S OFFICE AT THE
REQUEST OF THE DIRECTOR OF PUBLIC WORKS.

THE 1 LOT WITHIN SPR 06-19 IS SUBJECT TO ANNUAL
ASSESSMENTS BY THE CITY OF LANCASTER FOR THE MAINTENANCE OF THE
DRAINAGE IMPROVEMENTS WITHIN THE DRAINAGE MAINTENANCE DISTRICT.

THE AREA OF THIS ASSESSORS PARCEL WAS SUBSEQUENTLY APPROVED
FOR DEVELOPMENT, KNOWN AS SPR 06-19.

THE CITY COUNCIL APPROVED ANNEXATION OF THIS PARCEL ON
JULY 8, 2008.

OWNERS: HAGOP HAROUTEOUN KETENJIAN AND CYNTHIA MARY KETENJIAN, TRUSTEE OF HAGOP AND CYNTHIA KETENJIAN LIVING TRUST.



N.T.S.

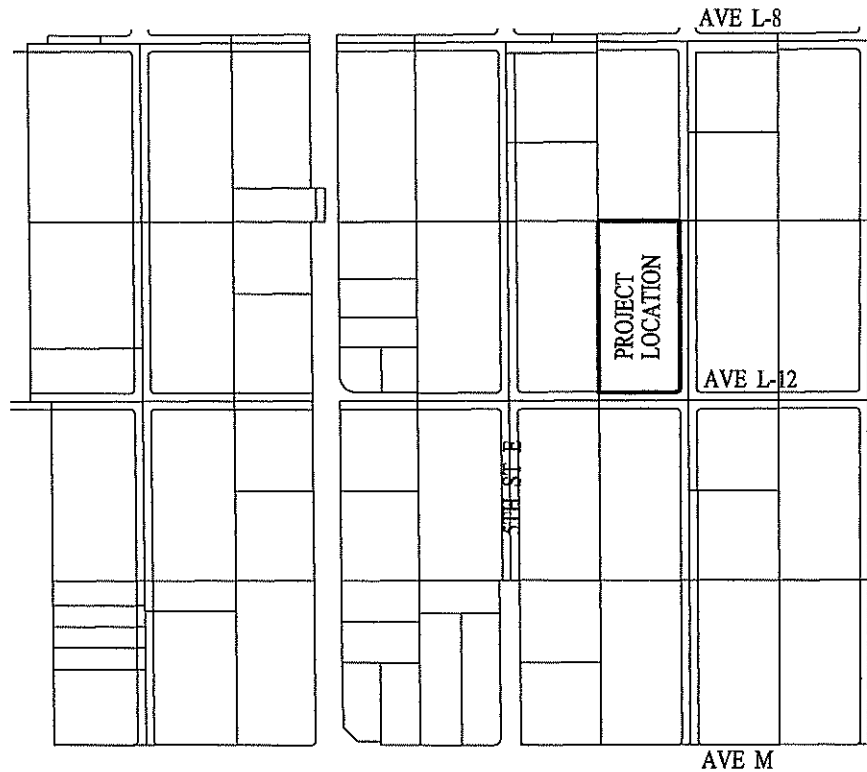

EXHIBIT "A"

DIAGRAM FOR
PROPOSED ANNEXATION NO. 07-59
LANCASTER DRAINAGE MAINTENANCE DISTRICT
CITY OF LANCASTER
COUNTY OF LOS ANGELES, STATE OF CALIFORNIA

DIAGRAM PREPARED IN THE OFFICE OF PUBLIC WORKS DIRECTOR
CITY OF LANCASTER

PREPARED BY:

CARLYLE S. WORKMAN, CITY ENGINEER
R.C.E. C45024, EXPIRES 3/31/10

FILED IN THE OFFICE OF CITY CLERK OF THE CITY OF LANCASTER THIS
____ DAY OF _____, 2008

GERI K. BRYAN, CITY CLERK
CITY OF LANCASTER

LEGEND

_____ BOUNDARY OF PROPOSED ANNEXATION

A DETAILED DESCRIPTION OF THE LINES AND DIMENSIONS OF THE
PARCEL SHALL BE AS SHOWN ON LOS ANGELES COUNTY ASSESSORS
MAPS FOR FISCAL YEAR 07-08 AS INDICATED BELOW AND SHALL
GOVERN FOR ALL DETAILS.

ASSESSOR MAP, PAGE, AND PARCEL 3111-018-039.

THIS DIAGRAM IS BEING FILED IN THE CITY CLERK'S OFFICE AT THE
REQUEST OF THE DIRECTOR OF PUBLIC WORKS.

THE 1 LOT WITHIN PMT 07-01218 IS SUBJECT TO ANNUAL
ASSESSMENTS BY THE CITY OF LANCASTER FOR THE MAINTENANCE OF THE
DRAINAGE IMPROVEMENTS WITHIN THE DRAINAGE MAINTENANCE DISTRICT.

THE AREA OF THIS ASSESSORS PARCEL WAS SUBSEQUENTLY APPROVED
FOR DEVELOPMENT, KNOWN AS PMT NO. 07-01218.

THE CITY COUNCIL APPROVED ANNEXATION OF THIS PARCEL ON
JULY 8, 2008.

OWNERS: CAMINO HERMANOS I, LLC



N.T.S.

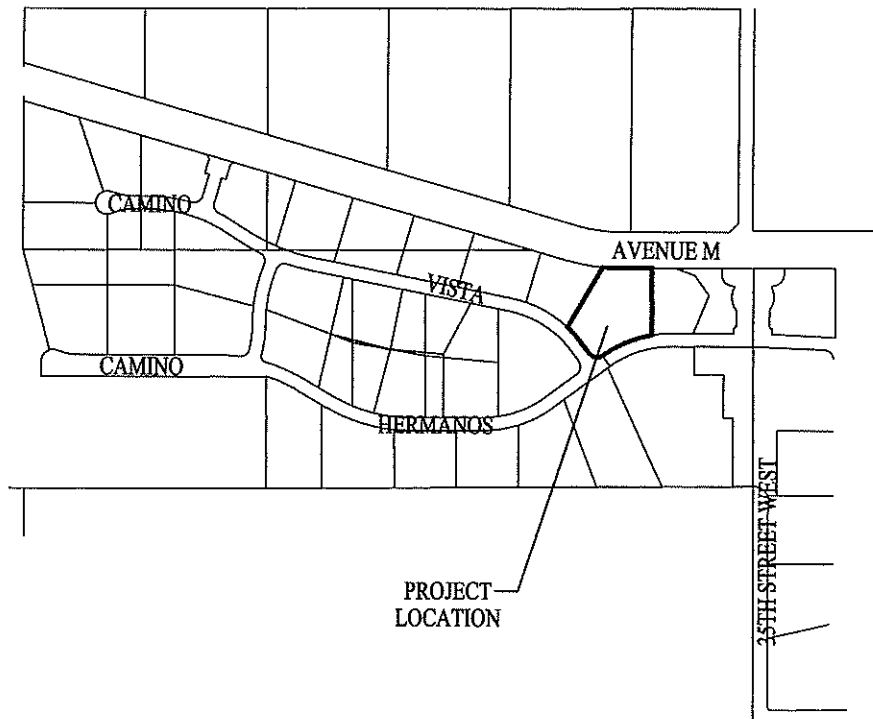

EXHIBIT "A"

DIAGRAM FOR
PROPOSED ANNEXATION NO. 08-17
LANCASTER DRAINAGE MAINTENANCE DISTRICT
CITY OF LANCASTER
COUNTY OF LOS ANGELES, STATE OF CALIFORNIA

DIAGRAM PREPARED IN THE OFFICE OF PUBLIC WORKS DIRECTOR
CITY OF LANCASTER

PREPARED BY:

CARLYLE S. WORKMAN, CITY ENGINEER
R.C.E. C45024, EXPIRES 3/31/10

FILED IN THE OFFICE OF CITY CLERK OF THE CITY OF LANCASTER THIS
____ DAY OF _____, 2008

GERI K. BRYAN, CITY CLERK
CITY OF LANCASTER

LEGEND

_____ BOUNDARY OF PROPOSED ANNEXATION

A DETAILED DESCRIPTION OF THE LINES AND DIMENSIONS OF THE
PARCEL SHALL BE AS SHOWN ON LOS ANGELES COUNTY ASSESSORS
MAPS FOR FISCAL YEAR 07-08 AS INDICATED BELOW AND SHALL
GOVERN FOR ALL DETAILS.

ASSESSOR MAP, PAGE, AND PARCEL 3154-007-041.

THIS DIAGRAM IS BEING FILED IN THE CITY CLERK'S OFFICE AT THE
REQUEST OF THE DIRECTOR OF PUBLIC WORKS.

THE 1 LOT WITHIN PMT 07-03714 IS SUBJECT TO ANNUAL
ASSESSMENTS BY THE CITY OF LANCASTER FOR THE MAINTENANCE OF THE
DRAINAGE IMPROVEMENTS WITHIN THE DRAINAGE MAINTENANCE DISTRICT.

THE AREA OF THIS ASSESSORS PARCEL WAS SUBSEQUENTLY APPROVED
FOR DEVELOPMENT, KNOWN AS PMT NO, 07-03714.

THE CITY COUNCIL APPROVED ANNEXATION OF THIS PARCEL ON
JULY 8, 2008.

OWNERS: JOSEPHINE ROMAN, AN UNMARRIED WOMAN



N.T.S.

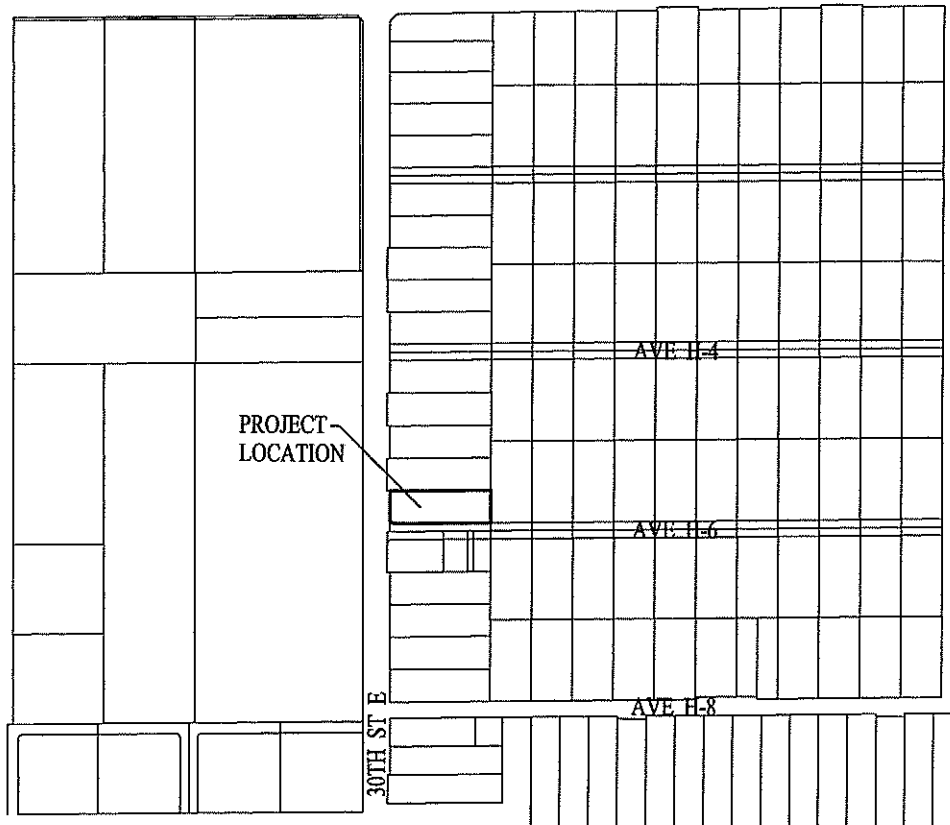

EXHIBIT "A"

DIAGRAM FOR
PROPOSED ANNEXATION NO. 08-18
LANCASTER DRAINAGE MAINTENANCE DISTRICT
CITY OF LANCASTER
COUNTY OF LOS ANGELES, STATE OF CALIFORNIA

DIAGRAM PREPARED IN THE OFFICE OF PUBLIC WORKS DIRECTOR
CITY OF LANCASTER

PREPARED BY:

CARLYLE S. WORKMAN, CITY ENGINEER
R.C.E. C45024, EXPIRES 3/31/10

FILED IN THE OFFICE OF CITY CLERK OF THE CITY OF LANCASTER THIS
____ DAY OF _____, 2008

GERI K. BRYAN, CITY CLERK
CITY OF LANCASTER

LEGEND

_____ BOUNDARY OF PROPOSED ANNEXATION

A DETAILED DESCRIPTION OF THE LINES AND DIMENSIONS OF THE
PARCEL SHALL BE AS SHOWN ON LOS ANGELES COUNTY ASSESSORS
MAPS FOR FISCAL YEAR 07-08 AS INDICATED BELOW AND SHALL
GOVERN FOR ALL DETAILS.

ASSESSOR MAP, PAGE, AND PARCEL 3146-006-022.

THIS DIAGRAM IS BEING FILED IN THE CITY CLERK'S OFFICE AT THE
REQUEST OF THE DIRECTOR OF PUBLIC WORKS.

THE 1 LOT WITHIN PMT 07-04219 IS SUBJECT TO ANNUAL
ASSESSMENTS BY THE CITY OF LANCASTER FOR THE MAINTENANCE OF THE
DRAINAGE IMPROVEMENTS WITHIN THE DRAINAGE MAINTENANCE DISTRICT.

THE AREA OF THIS ASSESSORS PARCEL WAS SUBSEQUENTLY APPROVED
FOR DEVELOPMENT, KNOWN AS PMT NO, 07-04219.

THE CITY COUNCIL APPROVED ANNEXATION OF THIS PARCEL ON
JULY 8, 2008.

OWNERS: JOSEPHINE ROMAN, AN UNMARRIED WOMAN



N.T.S.

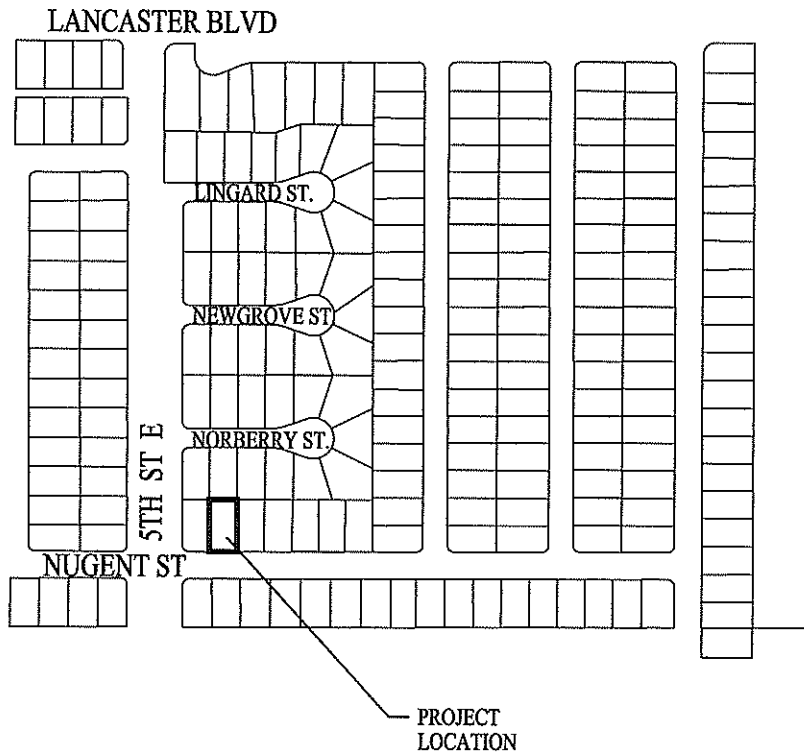

EXHIBIT "A"

DIAGRAM FOR
PROPOSED ANNEXATION NO. 08-20
LANCASTER DRAINAGE MAINTENANCE DISTRICT
CITY OF LANCASTER
COUNTY OF LOS ANGELES, STATE OF CALIFORNIA

DIAGRAM PREPARED IN THE OFFICE OF PUBLIC WORKS DIRECTOR
CITY OF LANCASTER

PREPARED BY:

CARLYLE S. WORKMAN, CITY ENGINEER
R.C.E. C45024, EXPIRES 3/31/10

FILED IN THE OFFICE OF CITY CLERK OF THE CITY OF LANCASTER THIS
____ DAY OF _____, 2008

GERI K. BRYAN, CITY CLERK
CITY OF LANCASTER

LEGEND

_____ BOUNDARY OF PROPOSED ANNEXATION

A DETAILED DESCRIPTION OF THE LINES AND DIMENSIONS OF THE
PARCEL SHALL BE AS SHOWN ON LOS ANGELES COUNTY ASSESSORS
MAPS FOR FISCAL YEAR 07-08 AS INDICATED BELOW AND SHALL
GOVERN FOR ALL DETAILS.

ASSESSOR MAP, PAGE, AND PARCEL 3126-004-060, 3126-004-007,
3126-004-057, 3126-004-058.

THIS DIAGRAM IS BEING FILED IN THE CITY CLERK'S OFFICE AT THE
REQUEST OF THE DIRECTOR OF PUBLIC WORKS.

THE 4 LOTS WITHIN SPR 07-15 IS SUBJECT TO ANNUAL
ASSESSMENTS BY THE CITY OF LANCASTER FOR THE MAINTENANCE OF THE
DRAINAGE IMPROVEMENTS WITHIN THE DRAINAGE MAINTENANCE DISTRICT.

THE AREA OF THIS ASSESSORS PARCEL WAS SUBSEQUENTLY APPROVED
FOR DEVELOPMENT, KNOWN AS SPR 07-15.

THE CITY COUNCIL APPROVED ANNEXATION OF THIS PARCEL ON
JULY 8, 2008.

OWNERS: YASSER MUBARKEH AND NASHWA MUBARKEH HUSBAND AND WIFE AS JOINT TENANTS AS TO AN UNDIVIDED 50% INTEREST AND ELIAS
MBARKEH AND KAHRAMANAH MBARKEH HUSBAND AND WIFE AS JOINT TENANTS AS TO AN UNDIVIDED 50% INTEREST

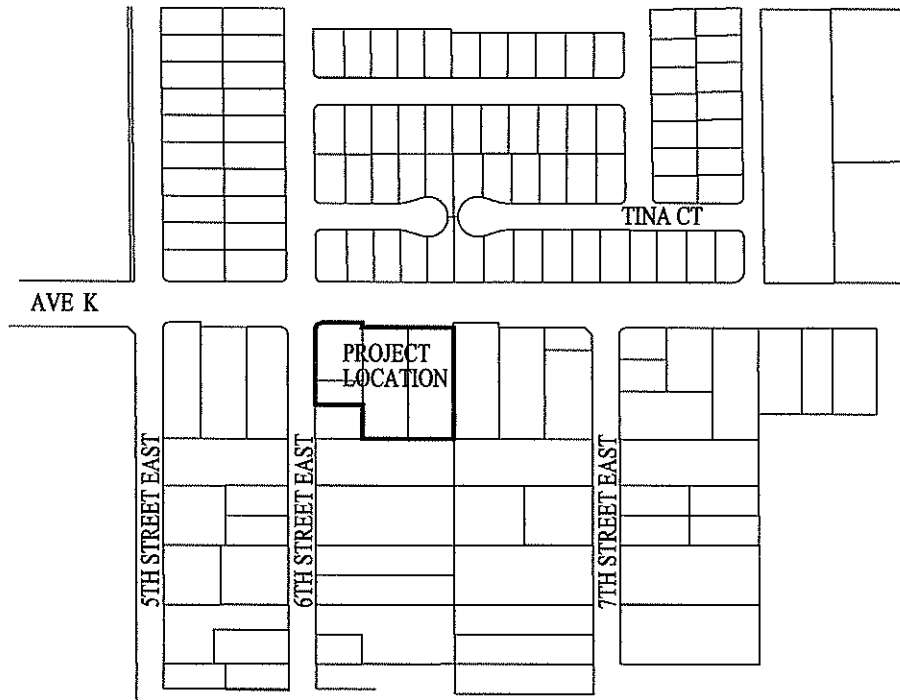

EXHIBIT "A"